

SPECIFICATIONS
 Current Rating: 1A AC/DC
 Current Voltage: 150V AC/DC
 Withstand Voltage: 500V AC/Min(rms)
 Working Temperature: -25°C~+85°C
 Insulation Resistance: ≥500MΩ min.
 Contact Resistance: ≤30mΩ max.

MATERIAL
 Terminal: Phosphor Bronze
 Housing: Thermoplastic, UL94V-0
 Fitting Nail: Copper Alloy, Tin Plated

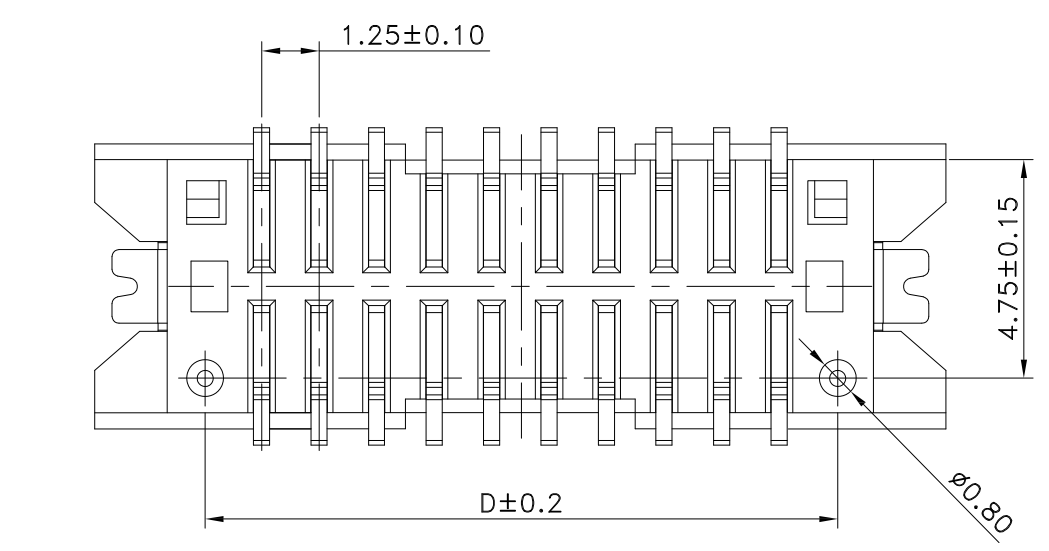
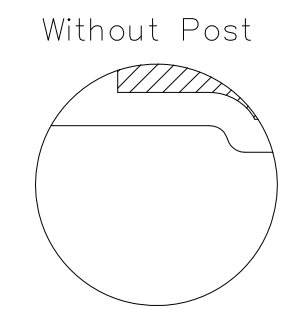
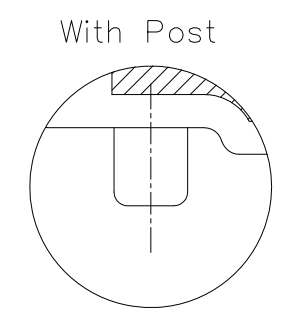
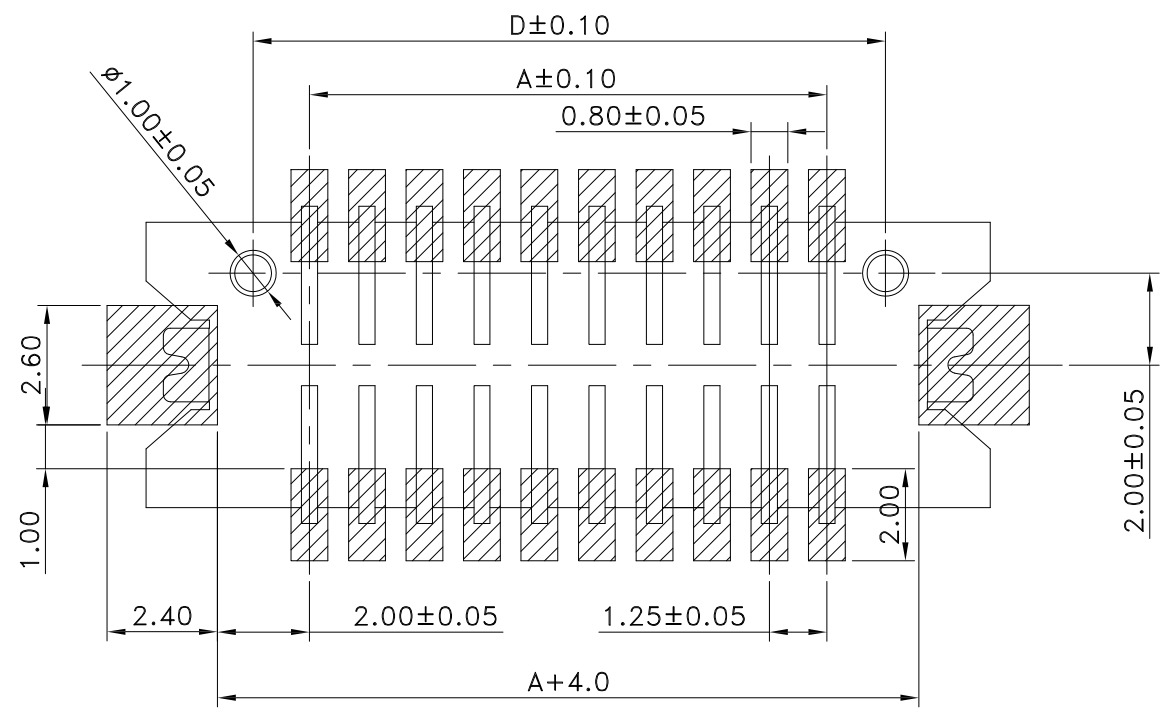
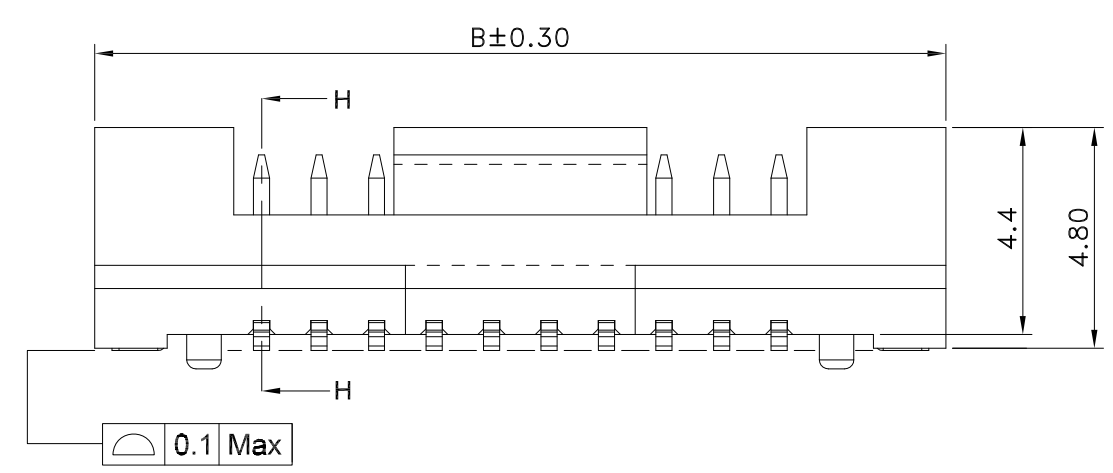

Recommended P.C.B. Layout

RoHS
Compliant

Poles	Dimension			
	A	B	C	D
10	5.00	12.10	8.10	7.50
20	11.25	18.35	14.35	13.75
30	17.50	24.60	20.60	20.00
40	23.75	30.85	26.85	26.25

Ordering Information

WE - 4 - XX - PT - 56X X - X-81

1.25Ph Wafer Solder/PCB 10~40Pin Contact Plated Housing Material Color
 N:Nature
 B:Black
 N:No Post
 W:With Post

1:DIP RA
 2:DIP VT
 3:SMT RA
 4:SMT VT

GT: Gold
 PT: Tin

A:PA9T
 B:PA6T
 C:PA66

REV.	REVISION RECORD	DATE	General Tolerance
A	Original	03/28/22	LINEAR 0.0 ±0.25 ANGLE ±3° 0.00 ±0.20
			UNIT: mm
			A4 NAME
			APPROVED KENNY
			DESIGNER GRACE
			DRAWN CHAOSHIN



TITLE: 1.25Ph Wafer SMT Vertical 4.8H
 DWG.NO: WE4XXPT56XXW-81 REV. A
 SCALE 1 : 1 SHEET 1 OF 1