

	1	2	3	4	5	6	7	8
A	Poles	DIM.A	DIM.B					
	2P	2.0	6.1					
B	3P	4.0	8.1					
	4P	6.0	10.1					
C	5P	8.0	12.1					
	6P	10.0	14.1					
D	7P	12.0	16.1					
	8P	14.0	18.1					
E	9P	16.0	20.1					
	10P	18.0	22.1					
F	11P	20.0	24.1					
	12P	22.0	26.1					
G	13P	24.0	28.1					
	14P	26.0	30.1					
H	15P	28.0	32.1					
	16P	30.0	34.1					

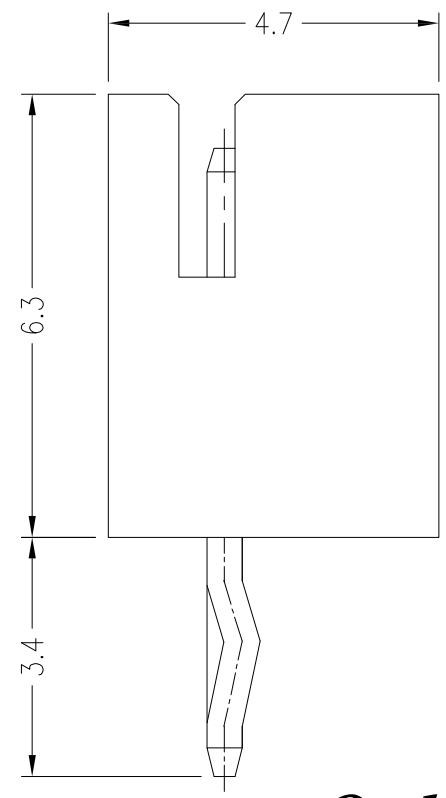
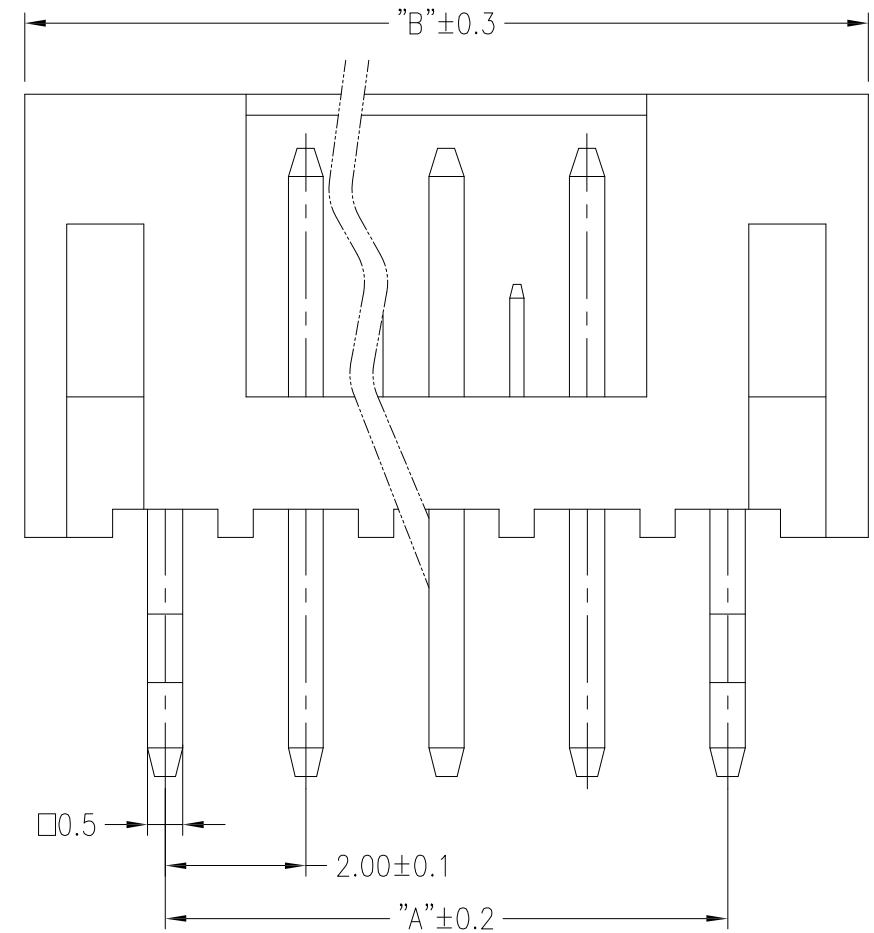
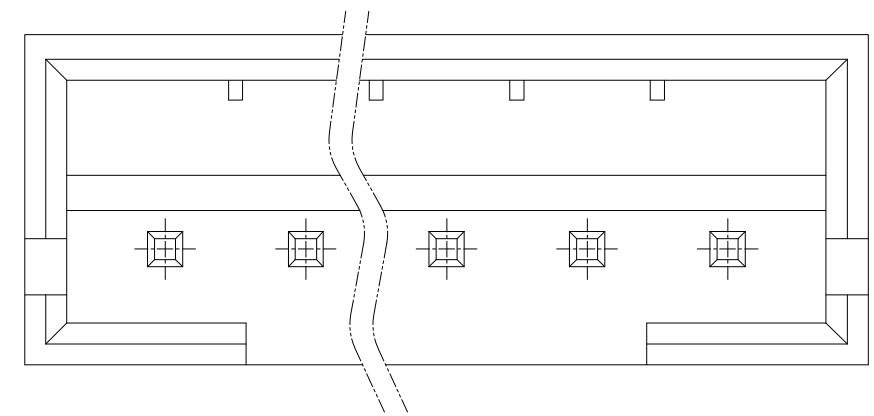

**SPECIFICATIONS:**  
 Applicable Wire: AWG#24~#28  
 Voltage Rating: 100V AC/DC(rms)  
 Current Rating: 2.0A AC/DC(AWG#24)  
 Withstand voltage: 800V AC/Min(rms)  
 Operating Temperature: -25°C~+85°C  
 Insulation Resistance: 1000MΩ min.  
 Contact Resistance: 30mΩ max.

**MATERIAL:**  
 Terminal: Brass  
 Housing: PA66,UL94V-0,Natural

RoHS  
Compliant

### Ordering Information

**WG - 2 - XX - PT - YE28-1-44**

2.0Ph Wafer    Solder/PCB 2:DIP VT    Total Pin    Contact Plated PT: Tin    Packaging 1: Bag

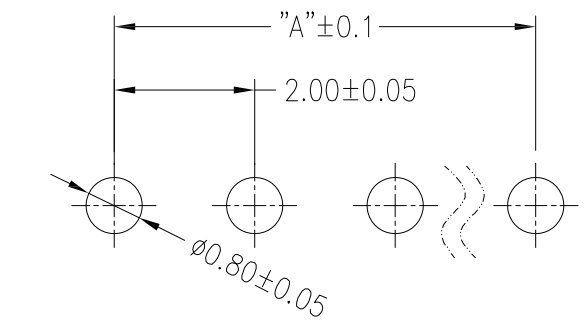

RECOMMENDED PCB LAYOUT

REV.	REVISION RECORD	DATE	General Tolerance		
A	Original	11/09/21	LINEAR	0.0 ±0.25 ANGLE ±3° 0.00 ±0.20	
				UNIT: mm	TITLE: 2.0Ph Wafer DIP Vertical Kink Legs 6.3H
			APPROVED	KENNY	DWG.NO: <b>WG2XXPTYE281-44</b> REV. A
			CHECKED	GRACE	SCALE 1 : 1 SHEET 1 OF 1
			DESIGNER	JNDAR	